

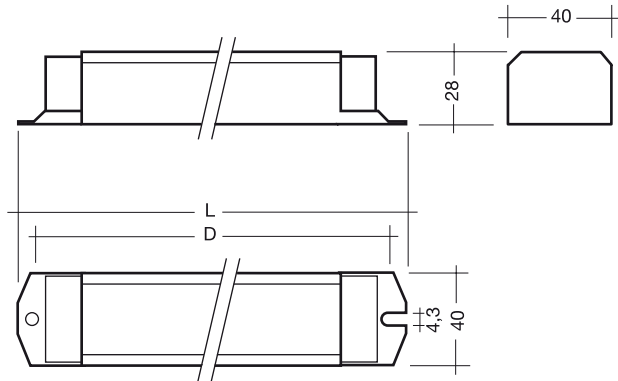

PCA 3/14 T5 ECO / 4/14 T5 ECO 220–240 V 50/60/0 Hz



- dimming range from 10-100 %
- lamp start at 10 %
- defined lamp warm start within 1.5 s with AC and 0.6 s with DC
- switch via the mains or with digital control signal
- dimming which is comfortable to the eye
- disturbance free precise control with a digital DSI signal or switchDIM
- integrated SMART interface
- fully electronic lamp management and digital communication with ASIC and μ C

- constant light output independent of fluctuating supply voltage
- DC operation in emergency lighting installations to EN 50172
- automatically triggered 70 % emergency light value for DC and rectified AC voltage (please refer to data sheet)
- safe shutdown of defective lamps
- safe shutdown of lamps at end of life (rectifying effect)
- automatic restart after lamp replacement
- operating frequency ~40-100 kHz

Packaging:
box of 20
30 boxes/pallet
600 pieces/pallet

Wiring:
page 95 figure D, E, F
page 99 figure S

Approvals:
EN 55015
EN 55022
EN 60929
EN 61000-3-2
EN 61347-2-3
EN 61547
suitable for emergency light installations as per EN 50172

| Lamp | | Ballast | | | | | | | | | | |
|-------------------|--------------|--------------------------------------|-------------------|----------------|---------------------------|--------------|----------------------|-------------------------|--------------------------------|---------------------------|----------------|------------------------------|
| watt- age W | length mm | type | article number | length L mm | fixing centres D mm | weight kg | lamp power W ② | circuit power W ② | current at 230V/50Hz A ② | λ at 230V/50Hz | tc point °C | temperature range °C ① |
| 3x14 | 550 | PCA 3/14 T5 ECO 220–240 V 50/60/0 Hz | 22086661 | 360 | 340-350 | 0.38 | 42 | 51.6 | 0.23 | 0.98 | 80 | +10 → +50 |
| 4x14 | 550 | PCA 4/14 T5 ECO 220–240 V 50/60/0 Hz | 22086683 | 360 | 340-350 | 0.40 | 56 | 66.5 | 0.32 | 0.98 | 80 | +10 → +60 |

① 10 °C to t_a max: dimming to 10 %

② valid at 100 % light output